



MAITRE D'OUVRAGE



HOPITAL LOUIS MOURIER  
178 rue des Renouillers - 92700 COLOMBES

Restructuration du 7e NORD - Louis Mourier

<p>MAITRISE D'OUVRAGE</p> <p>APHP Nord Université Paris Cité</p> <p>HOPITAL LOUIS MOURIER</p> <p>178 rue des Renouillers - 92700 COLOMBES</p>											
<p>MAITRISE D'OEUVRE</p> <p>BIM INGENIERIE</p> <p>21, avenue Edouard Belin 92500 Rueil-Malmaison</p> <p>Tél : 06 33 86 56 10</p> <p>Courriel : djamel.boudifa@bimingenierie.fr</p>											
<p>DOSSIER: Plan installation de chantier</p>											
<p>DCE</p>								<p>00</p>			
<p>Affaire</p>	<p>BAT</p>	<p>Emetteur</p>	<p>Date</p>	<p>Phase</p>	<p>Type</p>	<p>N°</p>	<p>Niveau</p>	<p>Zone</p>	<p>Indice</p>	<p>Echelle</p>	
<p>BIM25_28</p>	<p>IGH</p>	<p>BIM</p>	<p>Jan 2026</p>	<p>DCE</p>	<p>IMP</p>	<p>00</p>	<p>R+7</p>	<p>TZ</p>	<p>B</p>	<p>1/-</p>	

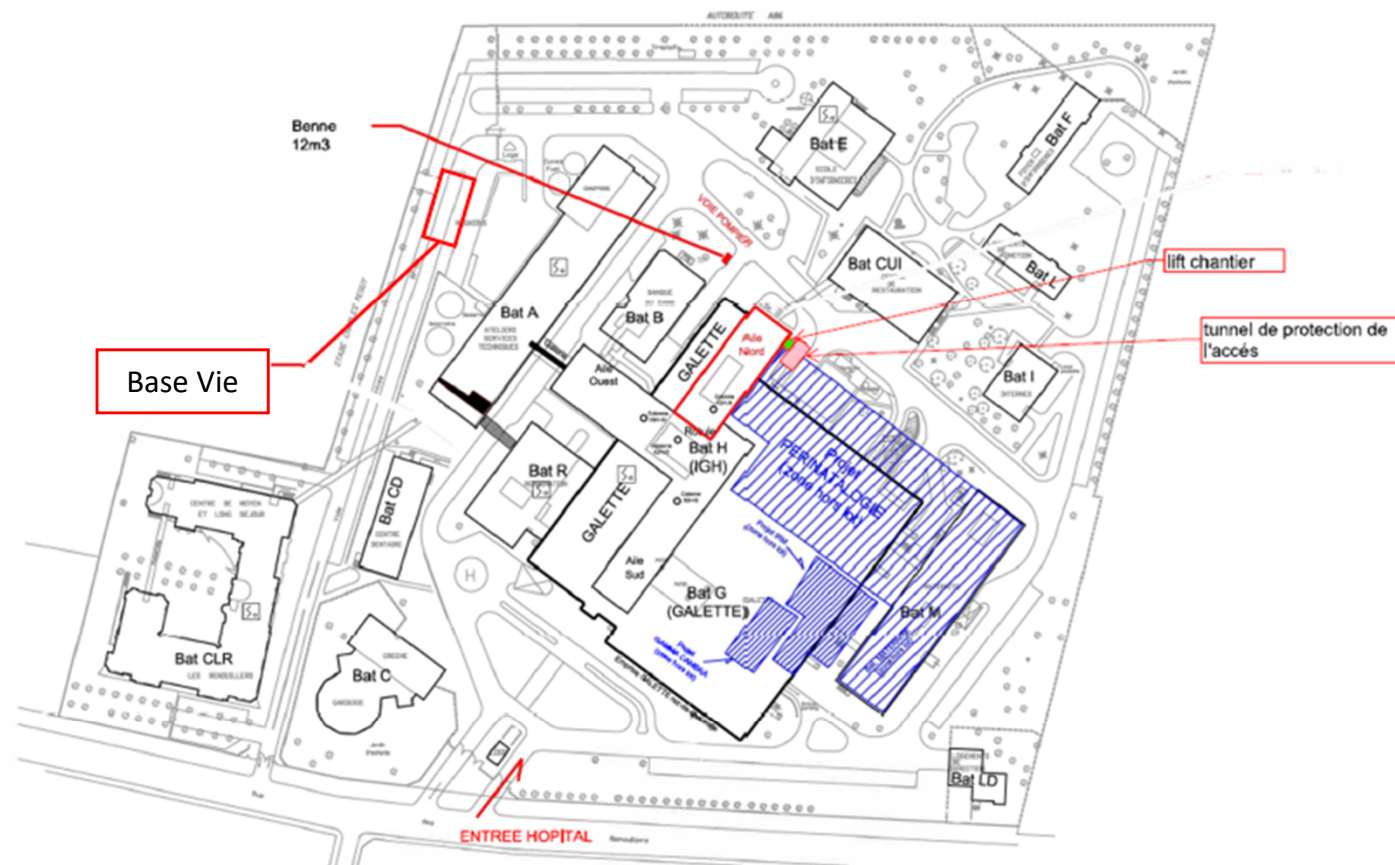

VOIE POMPIER

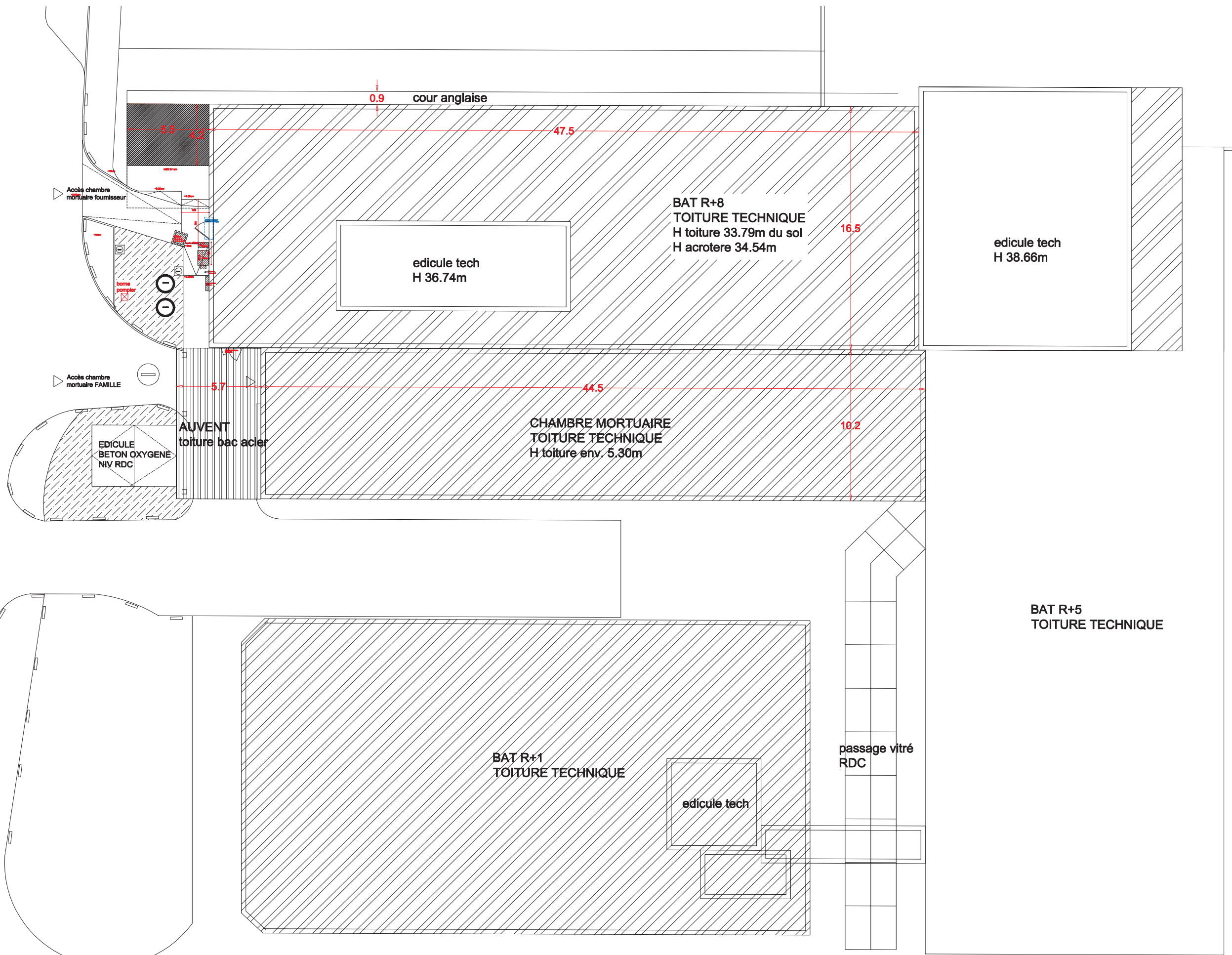



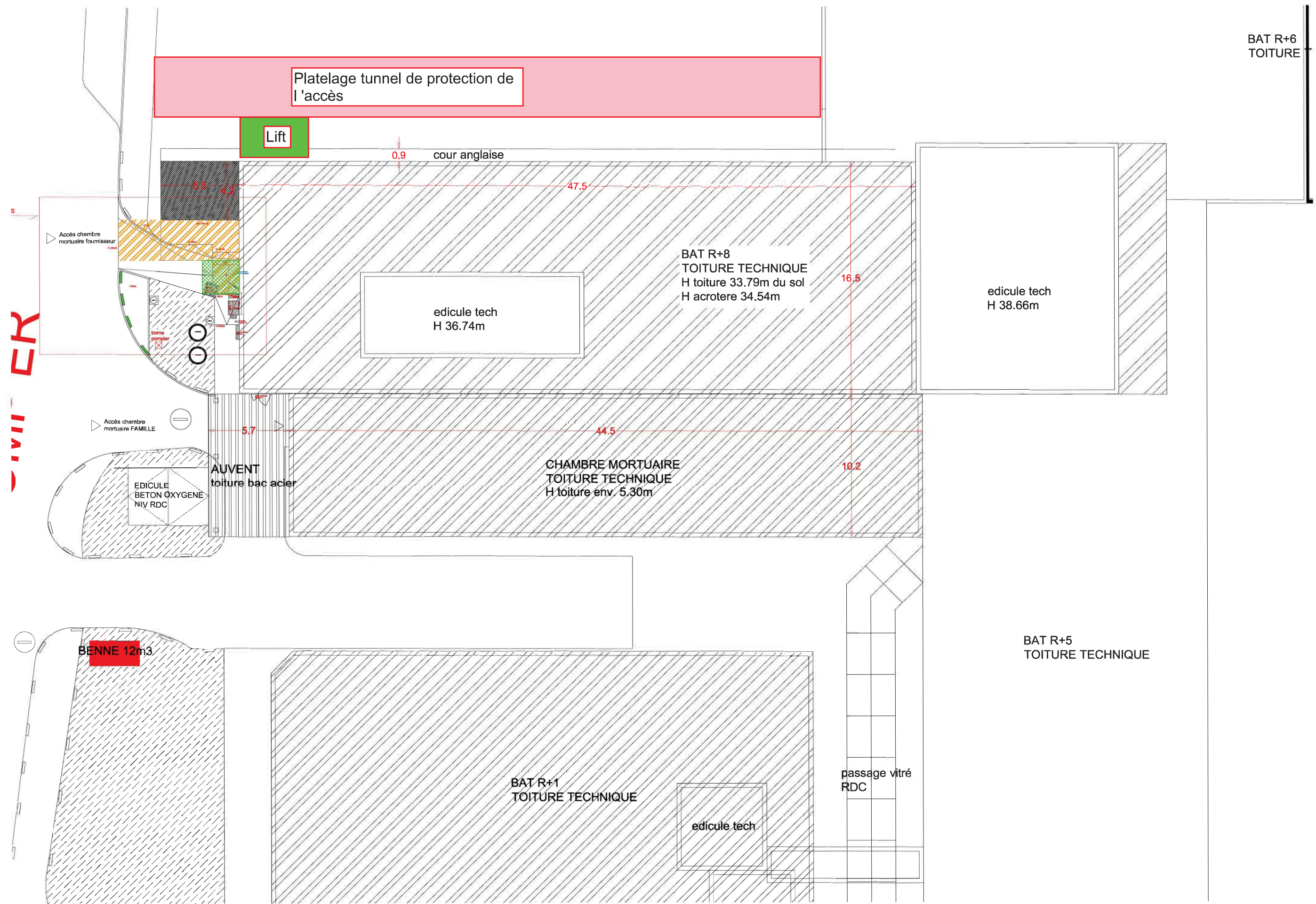



This architectural floor plan depicts a building section with various rooms and structural details. The plan includes the following elements:

- Rooms and Areas:**
  - Room 1 (Top Left):** Labeled with an elevation of **+10cm** and a width of **HSD 341cm**. It features orange diagonal hatching.
  - Room 2 (Top Center):** Labeled with an elevation of **+0.00cm**.
  - Room 3 (Bottom Left):** Labeled with an elevation of **+10cm**. It contains a **borne pompier** (fireman's post) and a curved wall with green rectangular elements.
  - Room 4 (Bottom Center):** Labeled with an elevation of **+0.00cm**. It contains two circular features labeled **cheminée** (chimney).
  - Room 5 (Bottom Right):** Labeled with an elevation of **+0.00cm**. It contains a **coupeur fluides médicaux** (medical fluid cutter) and a **colonne sèche n°4** (dry column n°4).
- Structural and Installation Details:**
  - Green Hatched Area:** A rectangular area with green cross-hatching, labeled **+90cm** and **gaine pompier accès vers cuisine** (fireman's duct access to kitchen).
  - Orange Hatched Area:** A rectangular area with orange diagonal hatching, labeled **+8cm** and **marbre 23cm**.
  - Blue Text:** **prise ventilateur GESENF aux étages** (fan outlet GESENF to floors).
  - Dimensions:** Various dimensions are noted, including **186**, **291**, **100,8**, **1100cm**, **150**, **23cm**, **15cm**, and **21**.
  - Other Labels:** **égout** (sewer) is labeled in two locations.

passage à laisser libre pour accès fournisseur morgue

bordures bétonnées à déposer/reposer

PM : remise en état après travaux